



Exchange Criteria for Euro Pallet Pool

In order to exchange pallets, the following criteria apply:



Branding mark left:

The branding of a European railway company, for example the DB-logon

Branding mark centre:

Allocated here are the branding mark of the „European Pallet Association“ EPAL and the manufacturer's code and the country ID, for example 'D' for Deutschland (Germany)

Branding mark right:

Here you should see the branding mark of the European Pallet Pool ,EUR'

Exakte Abmessungen:

800 x 1200 mm

Further quality indicators:

- handled bottom boards
- no wood knots on boards
- only dried wood allowed for boards (no fungus allowed)



Repair assurance nail symbol:

The nail symbol for repair assurance featuring the EPAL quality logo classifies a quality checked flat pallet. These quality checks can only be carried out by EPAL approved repair services.

Quality Control Bracket:

The quality control bracket featuring EPAL's quality logo assures that the flat pallet has passed the quality check.



W+H Paletten

W+H Paletten GmbH

Lesumdeich 7, 28719 Bremen

Telefon: 04 21/63 63 902

Fax: 04 21/63 98 741

paletten@w-und-h.de

www.w-und-h.de



Nail head marking:

All nails which have been used in the production of EPAL/EUR pallets, can be identified by their unique head markings which consist of two letters.

Only nails which are approved by EPAL and an independent evaluating body, can be used for the assembly of EPAL/EUR flat pallets.

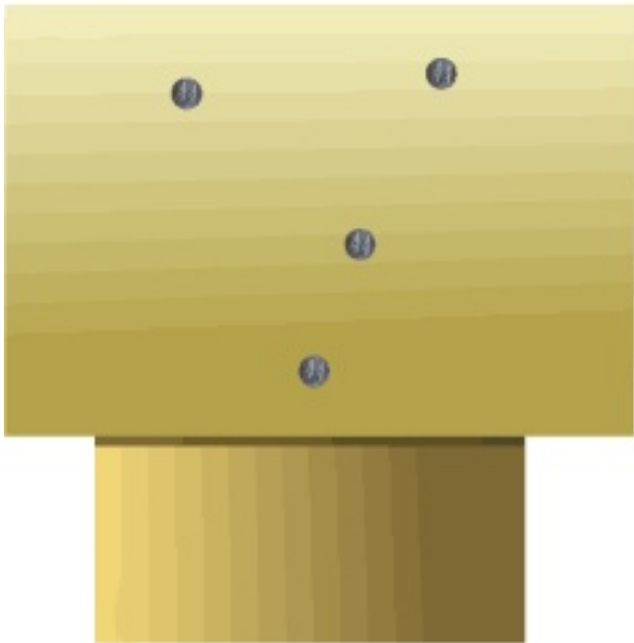

Nailing pattern:

78 nails ensure a diagonal rigidity of the pallet. Each position of the nails is defined.

Nailing pattern of the top deck panel-transverse board-centre block



W+H Paletten

W+H Paletten GmbH

Lesumdeich 7, 28719 Bremen

Telefon: 04 21/63 63 902

Fax: 04 21/63 98 741

paletten@w-und-h.de

www.w-und-h.de

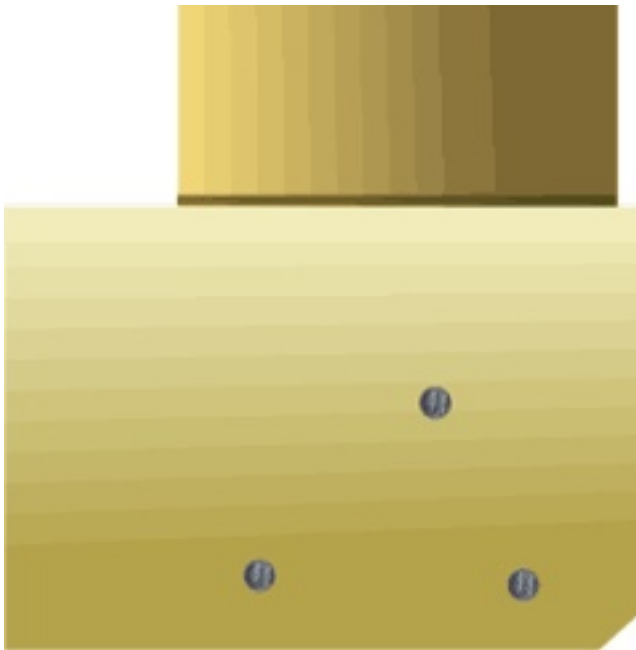

Nailing pattern of the top deck board-transverse board-corner block. The pattern is defined by manufacturing standard UIC 435-2.

Non-exchangeable pallets



The pallet is non-exchangeable...
if the EUR mark or the logo of a European railway company is missing.



The pallet is non-exchangeable...
if a single upper or lower edge board is damaged so that one nail or screw shank is revealed



The pallet is non-exchangeable...

if more than two lower or upper edge boards are split, so that more than one nail or screw shank is revealed

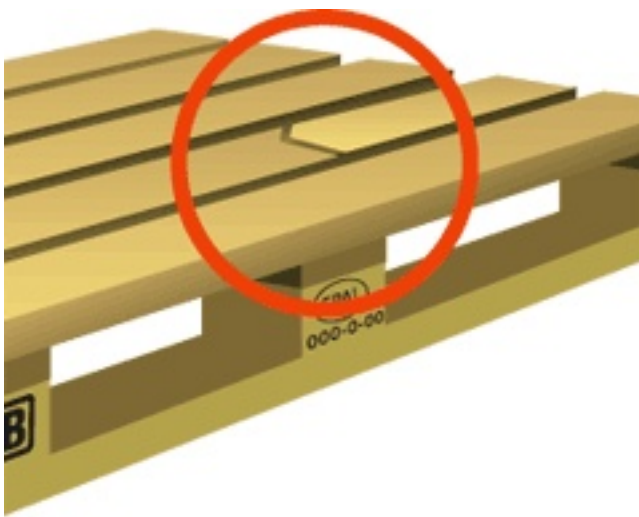

The pallet is non-exchangeable...

if a board is broken transversely or diagonally.



The pallet is non-exchangeable...

if a block is missing or split to the point where more than one nail shank is visible.



The pallet is non-exchangeable...
if a board is missing.

Other characteristics (Poor condition overall):

- The loading capacity can no longer be guaranteed (wood worm-eaten or rotten).
- Contamination is such that products may be soiled.
- Large splinters are coming away from a number of blocks.
- There is evidence that inadmissible construction elements have been used, e.g. boards and blocks

Grid box pallets

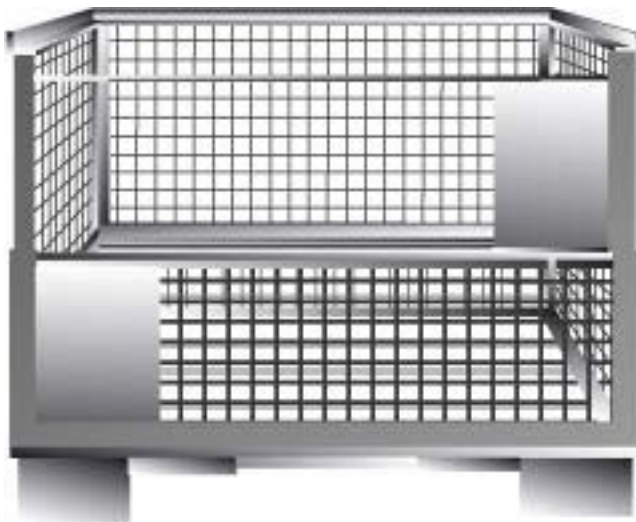

Only grid box pallets which have had a quality check will receive a repair badge with the EPAL quality badge.

Only the quality approved grid box pallets may have the quality approved badge containing the EPAL quality approved seal.

Quality characteristics:

- made with steel frame
- three way entry by fork lift truck
- three solid and permeable side wallse
- fourth wall contains two turnable flaps (180 degree around symmetry axis)
- Straight angle extension in order to stack additional grid boxes and flat pallets with identical dimensions
- Base made of wood



The grid box should withstand the following loading capacities:

- Universally distributed load of 1000kg, when the grid box pallet is placed on the forks of a lift truck.
- Additional 3300 kg stacked load when box pallet is static on an even and leveled surface.



Complete labeling

Grid box pallets need to have two black boards for labeling, notes, instructions etc.:

- Metal board on the right hand side for chalk notes and stick on labels.
- Metal board on the left hand side with the trademarked EUR sign and the signs of the accredited railway companies (DB, PKB etc.), their identification letter 'Y' and enrolment number.

In addition their net weight in kilograms, the maximum loading capacity in kilograms and loading volume: 0.75 square meters

Once repaired, the quality approved grid box pallets will receive their seal of repair containing the EPAL quality approval badge.

The enrolment number will be stamped and the EUR logo, the railways' logos and the logo of the manufacturers need to be imprinted inerasable on the board.